

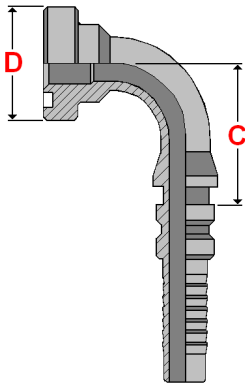

Balfit[®] Hydraulic Powerspir Hose Fittings

Balfit[®] Powerspir / Interlock Spiral 90° Swept SAE 6000 PSI (code 62) Flange - 26.7096

INTERNAL and EXTERNAL SKIVING solid-piece, carbon steel (code 62) 90° swept flanged fitting for crimping on very high pressure hydraulic hoses



According to **ISO 6162** and **ISO 12151-3** According to **SAE J516** and **SAE J518**

Material : carbon steel, zinc plated
(Ferrule 20.405) Hoses : **Balflex[®] Powerspir** multi-spiral hoses **DIN EN 856 4SH Hose** (1.1/4", 1.1/2" and 2")
(Ferrule 20.406) Hoses : **Balflex[®] Powerspir** multi-spiral hoses **DIN EN 856 4SH Hose** (3/4" and 1"),
SAE 100R13 Hose (all sizes) and **SAE 100R15 Hose** (all sizes)

part number	hose dash	hose Ø	Flange size	flange dash	D Ø Flange	C Cut Off	E
		inch	inch		mm	mm	mm
26.7096.1212	- 12	3/4"	3/4"	- 12	41,3	57	57
26.7096.1216	- 12	3/4"	1"	- 16	47,6	57	63
26.7096.1616	- 16	1"	1"	- 16	47,6	70	70
26.7096.1620	- 16	1"	1.1/4"	- 20	54,0	76	77
26.7096.2020	- 20	1.1/4"	1.1/4"	- 20	54,0	85	88
26.7096.2024	- 20	1.1/4"	1.1/2"	- 24	63,5	85	96
26.7096.2424	- 24	1.1/2"	1.1/2"	- 24	63,5	99	104
26.7096.2432	- 24	1.1/2"	2"	- 32	79,4	99	116
26.7096.3232	- 32	2"	2"	- 32	79,4	125	136

also available:

Balfit[®] Stainless Steel Powerspir 90° Swept SAE 6000 PSI (code 62) Flange

(add an 'S' at the end of the part number; ex: 26.7096.1212 S)

Construction characteristics and dimensions may be changed at any time without prior notice.

The data contained herein is information purposes only and does not enlarge, amend or imply any warranty other than provided by the manufacturer with the product. Any use of the product not in conformance with the manufacturer's instructions may be dangerous.

Only items in this catalogue are carried in stock. Some items are subjected to minimum quantities or sold only in multiples of standard quantities. Please refer to the price list or contact our commercial department.

Balflex[®] – The European Technology