

# Balfit<sup>®</sup> Hydraulic Powerspir Hose Fittings

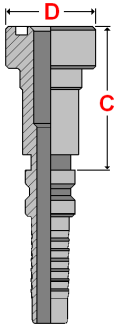

## Balfit<sup>®</sup> Powerspir / Interlock Spiral Straight SUPERCAT Flange 26.7116

**INTERNAL and EXTERNAL SKIVING**, carbon steel Supercat flanged fitting for crimping on very high pressure hydraulic hoses



According to **SAE J516** and **SAE J518**

**Material** : carbon steel, zinc plated  
**(Ferrule 20.405) Hoses** : **Balflex<sup>®</sup> Powerspir** multi-spiral hoses **DIN EN 856 4SH Hose** (1.1/4", 1.1/2" and 2")

**(Ferrule 20.406) Hoses** : **Balflex<sup>®</sup> Powerspir** multi-spiral hoses **DIN EN 856 4SH Hose** (3/4" and 1"),  
**SAE 100R13 Hose** (all sizes) and **SAE 100R15 Hose** (all sizes)

part number	hose dash	hose	Flange size	flange	D Ø Flange	C Cut Off
		Ø	inch	dash		
		inch	inch		mm	mm
26.7116.1212	- 12	3/4"	3/4"	- 12	41,3	58
26.7116.1216	- 12	3/4"	1"	- 16	47,6	64
26.7116.1616	- 16	1"	1"	- 16	47,6	65
26.7116.1620	- 16	1"	1.1/4"	- 20	54,0	73
26.7116.2020	- 20	1.1/4"	1.1/4"	- 20	54,0	74
26.7116.2024	- 20	1.1/4"	1.1/2"	- 24	63,5	78
26.7116.2424	- 24	1.1/2"	1.1/2"	- 24	63,5	80
26.7116.2432	- 24	1.1/2"	2"	- 32	79,4	85
26.7116.3232	- 32	2"	2"	- 32	79,4	85

Construction characteristics and dimensions may be changed at any time without prior notice.

The data contained herein is information purposes only and does not enlarge, amend or imply any warranty other than provided by the manufacturer with the product. Any use of the product not in conformance with the manufacturer's instructions may be dangerous.

Only items in this catalogue are carried in stock. Some items are subjected to minimum quantities or sold only in multiples of standard quantities. Please refer to the price list or contact our commercial department.

**Balflex<sup>®</sup> – The European Technology**