

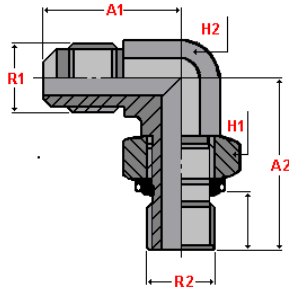

Balfit[®] SAE 37° Flared Pipe Fittings

Balfit[®] 90° Elbow JIC Male x BSPP Male – 35.600.

carbon steel 90° elbow JIC male x BSPP parallel male connector



According to **ISO 8434-2** According to **SAE J514**

Material: Carbon Steel

Finish: Zinc-plated

part number	Ø tube		thread		dimensions			
	mm	inch	R1	R2	A1	A2	H1	H2
35.600.0402	6	1/4"	7/16" - 20	1/8" - 28	23	26	11	11
35.600.0404	6	1/4"	7/16" - 20	1/4" - 19	27	32	14	14
35.600.0504	8	5/16"	1/2" - 20	1/4" - 19	27	33	14	14
35.600.0604	10	3/8"	9/16" - 18	1/4" - 19	27	32	14	14
35.600.0606	10	3/8"	9/16" - 18	3/8" - 19	29	37	19	19
35.600.0806	12	1/2"	3/4" - 16	3/8" - 19	32	37	19	19
35.600.0808	12	1/2"	3/4" - 16	1/2" - 14	34	43	22	22
35.600.1006	14	5/8"	7/8" - 14	3/8" - 19	37	43	22	22
35.600.1008	15	5/8"	7/8" - 14	1/2" - 14	43	43	22	22
35.600.1012	16	5/8"	7/8" - 14	3/4" - 14	37	50	27	36
35.600.1208	20	3/4"	1.1/16" - 12	1/2" - 14	42	50	27	27
35.600.1212	20	3/4"	1.1/16" - 12	3/4" - 14	42	50	27	36
35.600.1616	25	1"	1.5/16" - 12	1" - 11	46	52	33	41
35.600.2020	32	1.1/4"	1.5/8" - 12	1.1/4" - 11	52	57	41	50
35.600.2424	38	1.1/2"	1.7/8" - 12	1.1/2" - 11	59	61	48	55

also available:

Balfit[®] Stainless Steel 90° Elbow JIC Male x BSPP Male

(add an 'S' at the end of the part number; ex: 35.600.0808 S)

Construction characteristics and dimensions may be changed at any time without prior notice.

The data contained herein is information purposes only and does not enlarge, amend or imply any warranty other than provided by the manufacturer with the product. Any use of the product not in conformance with the manufacturer's instructions may be dangerous.

Only items in this catalogue are carried in stock. Some items are subjected to minimum quantities or sold only in multiples of standard quantities. Please refer to the price list or contact our commercial department.

Balflex[®] – The European Technology