

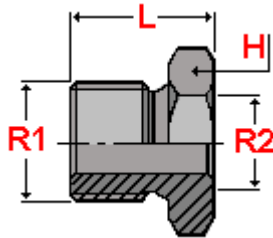

Balfit[®] Hydraulic Adapters

Balfit[®] BSPP Male x BSP Fixed Female Adapter – 52.5001

carbon steel BSPP Male x BSP Fixed Female Adapter



According to **ISO 8434-6**

Material: Carbon Steel, zinc plated

part number	working pressure	thread		L	H
		R1	R2		
	bar			mm	mm
52.5001.0604	250	3/8" – 19	1/4" – 19	22	22
52.5001.0804	225	1/2" – 14	1/4" – 19	25	27
52.5001.0806	225	1/2" – 14	3/8" – 19	25	27
52.5001.1206	200	3/4" – 14	3/8" – 19	27	32
52.5001.1208	200	3/4" – 14	1/2" – 14	27	32
52.5001.1606	160	1" – 11	3/8" – 19	30	38
52.5001.1608	160	1" – 11	1/2" – 14	30	38
52.5001.1612	160	1" – 11	3/4" – 14	30	38
52.5001.2012	160	1.1/4" – 11	3/4" – 14	34	50
52.5001.2016	160	1.1/4" – 11	1" – 11	34	50
52.5001.2416	160	1.1/2" – 11	1" – 11	35	55
52.5001.2420	160	1.1/2" – 11	1.1/4" – 11	35	55
52.5001.3220	100	2" – 11	1.1/4" – 11	43	70
52.5001.3224	100	2" – 11	1.1/2" – 11	43	70

also available:

Balfit[®] Stainless Steel BSPP Male x BSP Fixed Female Adapter

(add an 'S' at the end of the part number; ex: 52.5001.0806 S)

Construction characteristics and dimensions may be changed at any time without prior notice.

The data contained herein is information purposes only and does not enlarge, amend or imply any warranty other than provided by the manufacturer with the product. Any use of the product not in conformance with the manufacturer's instructions may be dangerous.

Only items in this catalogue are carried in stock. Some items are subjected to minimum quantities or sold only in multiples of standard quantities. Please refer to the price list or contact our commercial department.

Balflex[®] – The European Technology