

Balflex® Hydraulic Quick Couplings

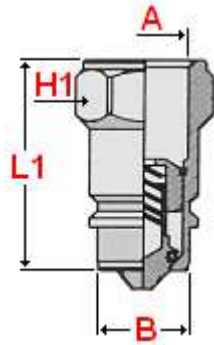

Balflex® Quick-Action Couplings DIN type (poppet valve)

quick-action coupling for high pressure hydraulic systems with poppet valve closure detail



40.D001 - Male

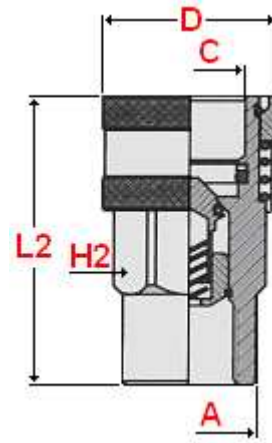

40.D002 - Female



Materials : carbon steel body, zinc plated, with synthetic rubber sealing rings and PTFE holding rings

Threads : female BSP or NPT

Valve closure detail : poppet valve

Maximum operating temperature : + 98°C / + 208°F (other materials for higher temperatures as special features)

Minimum operating temperature : - 20°C / - 4°F (other materials for lower temperatures as special features)

Application : agricultural and earth-moving machinery

| part number male BSP | part number female BSP | nom. size | dash size | working pressure | | dimensions (mm) | | | | | | | |
|-------------------------|---------------------------|--------------|--------------|---------------------|------|--------------------|------|----|----|------|----|----|-----|
| | | | | bar | PSI | A | B | H1 | L1 | C | D | H2 | L2 |
| 40.D001.04 | 40.D002.04 | 6,3 | - 4 | 350 | 5000 | 6,4 | 14,2 | 19 | 36 | 16,9 | 27 | 22 | 54 |
| 40.D001.06 | 40.D002.06 | 10 | - 6 | 300 | 4300 | 9,5 | 19,0 | 24 | 41 | 21,6 | 34 | 27 | 61 |
| 40.D001.12 | 40.D002.12 | 20 | - 12 | 250 | 3600 | 19,1 | 28,0 | 36 | 56 | 31,1 | 48 | 38 | 85 |
| 40.D001.16 | 40.D002.16 | 25 | - 16 | 230 | 3300 | 25,4 | 31,3 | 41 | 63 | 34,6 | 55 | 45 | 97 |
| 40.D001.20 | 40.D002.20 | 31,5 | - 20 | 220 | 3200 | 31,8 | 44,0 | 50 | 75 | 48,5 | 70 | 50 | 115 |

note : for dash size - 8 (1/2"), which is interchangeable with ISO type A, refer to parts 40.A001.08 and 40.A002.08

Balflex® Quick-Action Couplings DIN type with NPT thread

(change to '1' the third digit of the type sequence; ex: 40.D011.06)

Construction characteristics and dimensions may be changed at any time without prior notice.

The data contained herein is information purposes only and does not enlarge, amend or imply any warranty other than provided by the manufacturer with the product. Any use of the product not in conformance with the manufacturer's instructions may be dangerous.

Only items in this catalogue are carried in stock. Some items are subjected to minimum quantities or sold only in multiples of standard quantities. Please refer to the price list or contact our commercial department.

Balflex® – The European Technology