

Balflex[®] Hydraulic Ball Valves

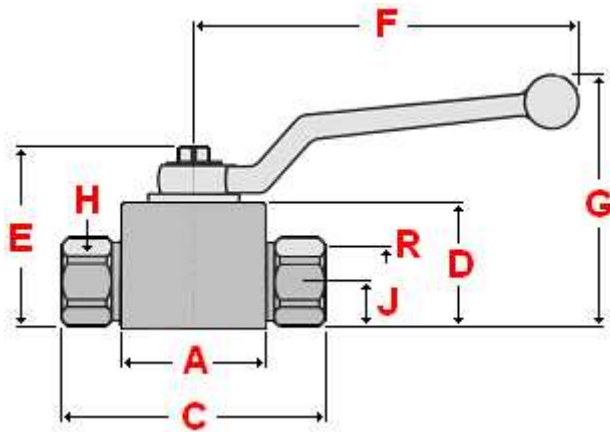

Balflex[®] 2-Way Directional Ball Valve - (BKH)

carbon steel ball valve for shut off of high pressure hydraulic lines



40.200B – 2-Way Ball Valve BSP or NPT Female

Directional Scheme: 2 1 2 1

Function : 2-way ball valve for shut off of hydraulic lines

Materials : carbon steel body, zinc plated; zamak handle, plated

Threads : female BSP or NPT

Maximum operating temperature : + 98°C / + 208°F (other materials for higher temperatures as special features)

Minimum operating temperature : - 0°C / + 32°F (other materials for lower temperatures as special features)

Application : high pressure hydraulic lines, agricultural equipment, mining industry, paint industry

part number	nominal size	working pressure		dimensions (mm)								
		inch	bar	PSI	R	A	C	D	E	F	G	H
40.200B.04	1/4"	500	7250	1/4"	40	72	35	47	110	64	22	13
40.200B.06	3/8"	500	7250	3/8"	45	75	40	52	110	69	27	16
40.200B.08	1/2"	500	7250	1/2"	50	85	45	56	110	76	30	18
40.200B.12	3/4"	250	3600	3/4"	60	93	58	75	150	96	41	23
40.200B.16	1"	250	3600	1"	65	114	65	86	150	104	46	28

also available:

Balflex[®] 2-Way Directional Ball Valve with NPT thread

(change to '1' the third digit of the type sequence; ex: 40.201B.08)

Construction characteristics and dimensions may be changed at any time without prior notice.

The data contained herein is information purposes only and does not enlarge, amend or imply any warranty other than provided by the manufacturer with the product. Any use of the product not in conformance with the manufacturer's instructions may be dangerous.

Only items in this catalogue are carried in stock. Some items are subjected to minimum quantities or sold only in multiples of standard quantities. Please refer to the price list or contact our commercial department.

Balflex[®] – The European Technology