

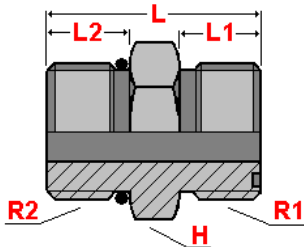

## Balfit<sup>®</sup> ORFS x SAE-ORB Straight Male Connector – 36.220.

carbon steel ORFS x SAE-ORB straight male connector



According to **ISO 8434-3** According to **SAE J1453**

**Material:** Carbon Steel

**Finish:** Zinc-plated

part number	Ø tube		thread		dimensions			
	mm	inch	R1	R2	L	L1	L2	H
36.220.0404	6	1/4"	9/16" – 18	7/16" – 20	28.7	10.9	10	17
36.220.0405	6	1/4"	9/16" – 18	1/2" – 20	28.7	10.9	10	17
36.220.0406	6	1/4"	9/16" – 18	9/16" – 18	30.5	12	10	17
36.220.0606	10	3/8"	11/16" – 16	9/16" – 18	31.9	12	11	19
36.220.0608	10	3/8"	11/16" – 16	3/4" – 16	35	14	11	22
36.220.0808	12	1/2"	13/16" – 16	3/4" – 16	36.6	14	13	22
36.220.0810	12	1/2"	13/16" – 16	7/8" – 14	40.4	16	13	27
36.220.1008	14	5/8"	1" – 14	3/4" – 16	45	14	15.5	27
36.220.1010	15	5/8"	1" – 14	7/8" – 14	43	16	15.5	27
36.220.1012	16	5/8"	1" – 14	1.1/16" – 12	47	18.5	15.5	32
36.220.1210	20	3/4"	1.3/16" – 12	7/8" – 14	48.5	16	17	32
36.220.1212	20	3/4"	1.3/16" – 12	1.1/16" – 12	48.5	18.4	17	32
36.220.1216	20	3/4"	1.3/16" – 12	1.5/16" – 12	50	18.5	17	38
36.220.1612	25	1"	1.7/16" – 12	1.1/16" – 12	50.5	18.6	17.5	41
36.220.1616	25	1"	1.7/16" – 12	1.5/16" – 12	50.5	18.7	17.5	41
36.220.2020	32	1.1/4"	1.11/16" – 12	1.5/8" – 12	52	18.5	17.5	46
36.220.2424	38	1.1/2"	2" – 12	1.7/8" – 12	54	18.5	17.5	55

also available:

## Balfit<sup>®</sup> Stainless Steel Straight Male Connector ORFS x SAE-ORB

(add an 'S' at the end of the part number; ex: 36.220.0808S)

Construction characteristics and dimensions may be changed at any time without prior notice.

The data contained herein is information purposes only and does not enlarge, amend or imply any warranty other than provided by the manufacturer with the product. Any use of the product not in conformance with the manufacturer's instructions may be dangerous.

Only items in this catalogue are carried in stock. Some items are subjected to minimum quantities or sold only in multiples of standard quantities. Please refer to the price list or contact our commercial department.

**Balflex<sup>®</sup> – The European Technology**