



Balfit[®] ORFS Fittings

Balfit[®] Orientable SAE-ORB Run Tee – 36.580.

carbon steel UNF male x ORFS male x ORFS male run tee connector

Balfit[®] Orientable SAE-ORB Branch Tee – 36.585.

carbon steel SAE-ORB male x ORFS male X ORFS male branch tee connector

SAE# 520428

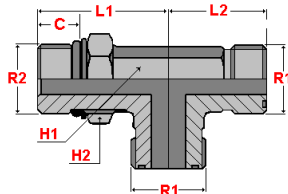

Balfit[®] Orientable SAE-ORB Run Tee – 36.580.

SAE# 520429

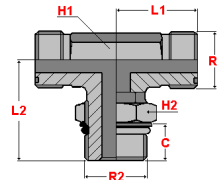

Balfit[®] Orientable SAE-ORB Branch Tee – 36.585.

According to ISO 8434-3 According to SAE J1453

Material: Carbon Steel

Finish: Zinc-plated

| part number | ∅ tube | | thread | | dimensions | | | |
|-------------|--------|--------|---------------|--------------|------------|------|----|----|
| | mm | inch | R1 | R2 | L1 | L2 | C | H1 |
| 36.580.0404 | 6 | 1/4" | 9/16" - 18 | 7/16" - 20 | 31.8 | 21.5 | 9 | 14 |
| 36.580.0606 | 10 | 3/8" | 11/16" - 16 | 9/16" - 18 | 36 | 25 | 10 | 19 |
| 36.580.0808 | 12 | 1/2" | 13/16" - 16 | 3/4" - 16 | 36.8 | 28 | 11 | 19 |
| 36.580.1010 | 15 | 5/8" | 1" - 14 | 7/8" - 14 | 48 | 33.5 | 13 | 27 |
| 36.580.1212 | 20 | 3/4" | 1.3/16" - 12 | 1.1/16" - 12 | 51 | 37.5 | 15 | 30 |
| 36.580.1616 | 25 | 1" | 1.7/16" - 12 | 1.5/16" - 12 | 57 | 41.5 | 15 | 36 |
| 36.580.2020 | 32 | 1.1/4" | 1.11/16" - 12 | 1.1/16" - 12 | 62 | 44.5 | 15 | 41 |
| 36.580.2424 | 38 | 1.1/2" | 2" - 12 | 1.5/16" - 12 | 65 | 49 | 15 | 48 |

| part number | ∅ tube | | thread | | dimensions | | |
|-------------|--------|--------|---------------|--------------|------------|------|----|
| | mm | inch | R1 | R2 | L1 | L2 | H2 |
| 36.585.0404 | 6 | 1/4" | 9/16" - 18 | 7/16" - 20 | 21.5 | 31.8 | 14 |
| 36.585.0606 | 10 | 3/8" | 11/16" - 16 | 9/16" - 18 | 25 | 36 | 19 |
| 36.585.0808 | 12 | 1/2" | 13/16" - 16 | 3/4" - 16 | 28 | 36.8 | 19 |
| 36.585.1010 | 15 | 5/8" | 1" - 14 | 7/8" - 14 | 33.5 | 48 | 27 |
| 36.585.1212 | 20 | 3/4" | 1.3/16" - 12 | 1.1/16" - 12 | 37.5 | 51 | 30 |
| 36.585.1616 | 25 | 1" | 1.7/16" - 12 | 1.5/16" - 12 | 41.5 | 57 | 36 |
| 36.585.2020 | 32 | 1.1/4" | 1.11/16" - 12 | 1.1/16" - 12 | 44.5 | 62 | 41 |
| 36.585.2424 | 38 | 1.1/2" | 2" - 12 | 1.5/16" - 12 | 49 | 65 | 48 |

also available:

Balfit[®] Stainless Steel Orientable SAE-ORB Run Tee

(add an 'S' at the end of the part number; ex: 36.580.0808S)

Balfit[®] Stainless Steel Orientable SAE-ORB Branch Tee

(add an 'S' at the end of the part number; ex: 36.585.0808S)

Construction characteristics and dimensions may be changed at any time without prior notice.

The data contained herein is information purposes only and does not enlarge, amend or imply any warranty other than provided by the manufacturer with the product. Any use of the product not in conformance with the manufacturer's instructions may be dangerous.

Only items in this catalogue are carried in stock. Some items are subjected to minimum quantities or sold only in multiples of standard quantities. Please refer to the price list or contact our commercial department.

Balflex[®] – The European Technology