

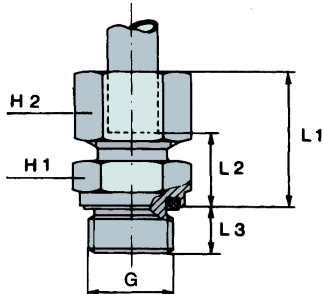

Balfit[®] Compression Ring Pipe Fittings

Balfit[®] BSP Male Connector with seal – 34.105.

carbon steel parallel BSP thread male stud 24° compression ring pipe fitting with rubber seal



According to **ISO 8434-1** According to **DIN 2353**

Material: Carbon Steel

Finish: Zinc-plated

part number	Ø tube	thread	dimensions						working pressure	ISO series
	mm	G	L1	L2	L3	H1	H2	MPa		
34.105.06LR02	6	1/8	23	8,5	8	14	14	31.5	L	
34.105.08LR04	8	1/4	25	10	12	19	17	31.5	L	
34.105.10LR04	10	1/4	26	11	12	19	19	31.5	L	
34.105.12LR06	12	3/8	27	12,5	12	22	22	31.5	L	
34.105.15LR08	15	1/2	29	14	14	27	27	31.5	L	
34.105.18LR08	18	1/2	31	14,5	14	27	32	31.5	L	
34.105.22LR12	22	3/4	33	16,5	16	32	36	16.0	L	
34.105.28LR16	28	1	34	17,5	18	41	41	16.0	L	
34.105.35LR20	35	1-1/4	39	17,5	20	50	50	16.0	L	
34.105.42LR24	42	1-1/2	42	19	22	55	60	16.0	L	
34.105.06SR04	6	1/4	28	13	12	19	17	63.0	S	
34.105.08SR04	8	1/4	30	15	12	19	19	63.0	S	
34.105.10SR06	10	3/8	31	15	12	22	22	63.0	S	
34.105.12SR06	12	3/8	33	17	12	22	24	63.0	S	
34.105.14SR08	14	1/2	37	19	14	27	27	63.0	S	
34.105.16SR08	16	1/2	37	18,5	14	27	30	40.0	S	
34.105.20SR12	20	3/4	42	20,5	16	32	36	40.0	S	
34.105.25SR16	25	1	47	23	18	41	46	40.0	S	
34.105.30SR20	30	1-1/4	50	23,5	20	50	50	40.0	S	
34.105.38SR24	38	1-1/2	57	26	22	55	60	31.5	S	
34.105.06LR04	6	1/4	24,5	10	12	19	14	31.5	L	
34.105.08LR02	8	1/8	24,5	9,5	8	17	17	31.5	L	

also available:

Balfit[®] Stainless Steel 24° Compression Ring

(add an 'S' at the end of the part number; ex: 34.105.06LR04S)

continued on next page

Construction characteristics and dimensions may be changed at any time without prior notice.

The data contained herein is information purposes only and does not enlarge, amend or imply any warranty other than provided by the manufacturer with the product. Any use of the product not in conformance with the manufacturer's instructions may be dangerous.

Only items in this catalogue are carried in stock. Some items are subjected to minimum quantities or sold only in multiples of standard quantities. Please refer to the price list or contact our commercial department.

Balflex[®] – The European Technology

Balfit® Compression Ring Pipe Fittings



continued

Balfit® BSP Male Connector with seal – 34.105.

carbon steel parallel BSP thread male stud 24° compression ring pipe fitting with rubber seal

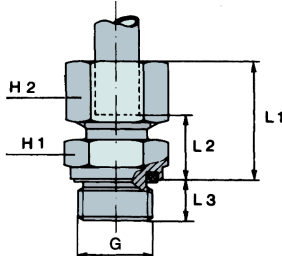

According to **ISO 8434-1** According to **DIN 2353**

Material: Carbon Steel

Finish: Zinc-plated

part number	Ø tube	thread	dimensions						working pressure	ISO series
	mm	G	L1	L2	L3	H1	H2	MPa		
34.105.08LR06	8	3/8	26,5	11,5	12	22	17	31,5	L	
34.105.08LR08	8	1/2	27	12	14	27	17	31,5	L	
34.105.10LR02	10	1/8	25,5	10,5	8	17	19	31,5	L	
34.105.10LR06	10	3/8	27,5	12,5	12	22	19	31,5	L	
34.105.10LR08	10	1/2	28	13	14	27	19	31,5	L	
34.105.12LR04	12	1/4	26,5	12	12	19	22	31,5	L	
34.105.12LR08	12	1/2	27,5	13	14	27	22	31,5	L	
34.105.15LR06	15	3/8	28,5	13,5	12	24	27	31,5	L	
34.105.18SR12	18	3/4	31	14,5	16	32	32	31,5	L	
34.105.12SR08	12	1/2	33,5	17,5	14	27	24	63,0	S	
34.105.14SR06	14	3/8	36,5	18,5	12	24	27	63,0	S	
34.105.16SR06	16	3/8	36,5	18	12	27	30	40,0	S	
34.105.20SR08	20	1/2	42	20,5	14	32	36	40,0	S	
34.105.25SR12	25	3/4	47	23	16	41	46	40,0	S	
34.105.30SR16	30	1	50	23,5	18	50	50	40,0	S	
34.105.08SR06	8	3/8	30,5	15,5	12	22	19	63,0	S	
34.105.10SR04	10	1/4	30,5	14,5	12	19	22	63,0	S	
34.105.10SR08	10	1/2	33,5	17,5	14	27	22	63,0	S	
34.105.12SR04	12	1/4	32,5	16,5	12	22	24	63,0	S	
34.105.16SR12	16	3/4	39	20,5	16	32	30	40,0	S	
34.105.20SR16	20	1	44	22,5	18	41	36	40,0	S	
34.105.38SR20	38	1-1/4	57	26	20	55	60	31,5	S	
34.105.15LR12	15	3/4	30	15	16	32	27	31,5	L	
34.105.22LR08	22	1/2	33	16,5	14	32	36	16,0	L	
34.105.22LR16	22	1	34	17,5	18	41	36	16,0	L	
34.105.28LR12	28	3/4	34	17,5	16	41	41	16,0	L	
34.105.35LR16	35	1	39	17,5	18	50	50	16,0	L	
34.105.06LR06	6	3/8	26	11,5	12	22	14	31,5	L	
34.105.42LR20	42	1-1/4	42	19	20	55	60	16,0	L	

also available:

Balfit® Stainless Steel 24° Compression Ring

(add an 'S' at the end of the part number; ex: 34.105.06LR04S)

Construction characteristics and dimensions may be changed at any time without prior notice.

The data contained herein is information purposes only and does not enlarge, amend or imply any warranty other than provided by the manufacturer with the product. Any use of the product not in conformance with the manufacturer's instructions may be dangerous.

Only items in this catalogue are carried in stock. Some items are subjected to minimum quantities or sold only in multiples of standard quantities. Please refer to the price list or contact our commercial department.

Balflex® – The European Technology