

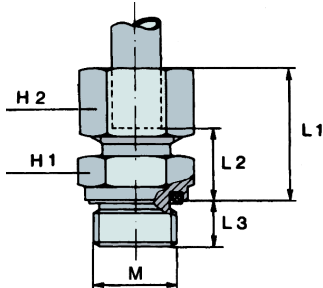

Balfit[®] Compression Ring Pipe Fittings

Balfit[®] Metric Male Connector with seal – 34.106.

carbon steel parallel Metric thread male stud 24° compression ring pipe fitting with rubber seal



According to **ISO 8434-1** According to **DIN 2353**

Material: Carbon Steel

Finish: Zinc-plated

part number	Ø tube mm	thread G	dimensions						working pressure MPa	ISO series
			L1	L2	L3	H1	H2	M		
34.106.06LM10	6	10x1	23	8,5	8	14	14		31.5	L
34.106.08LM12	8	12x1,5	25	10	12	17	17		31.5	L
34.106.10LM14	10	14x1,5	26	11	12	19	19		31.5	L
34.106.12LM16	12	16x1,5	27	12,5	12	22	22		31.5	L
34.106.15LM18	15	18x1,5	29	13,5	12	24	27		31.5	L
34.106.18LM22	18	22x1,5	31	14,5	14	27	32		31.5	L
34.106.22LM26	22	26x1,5	33	16,5	16	32	36		16.0	L
34.106.28LM33	28	33x2	34	17,5	18	41	41		16.0	L
34.106.35LM42	35	42x2	39	17,5	20	50	50		16.0	L
34.106.42LM48	42	48x2	42	19	22	55	60		16.0	L
34.106.06SM12	6	12x1,5	28	13	12	17	17		63.0	S
34.106.08SM14	8	14x1,5	30	15	12	19	19		63.0	S
34.106.10SM16	10	16x1,5	31	15	12	22	22		63.0	S
34.106.12SM18	12	18x1,5	33	17	12	24	24		63.0	S
34.106.14SM20	14	20x1,5	37	19	14	27	27		63.0	S
34.106.16SM22	16	22x1,5	37	18,5	14	27	30		40.0	S
34.106.20SM27	20	27x2	42	20,5	16	32	36		40.0	S
34.106.25SM33	25	33x2	47	23	18	41	46		40.0	S
34.106.30SM42	30	42x2	50	23,5	20	50	50		40.0	S
34.106.38SM48	38	48x2	57	26	22	55	60		31.5	S
34.106.08LM18	8	18x1,5	26,5	11,5	12	24	17		31.5	L
34.106.10LM16	10	16x1,5	27,5	12,5	12	22	19		31.5	L

also available:

Balfit[®] Stainless Steel 24° Compression Ring

(add an 'S' at the end of the part number; ex: 34.106.16SM22S)

continued on next page

Construction characteristics and dimensions may be changed at any time without prior notice.

The data contained herein is information purposes only and does not enlarge, amend or imply any warranty other than provided by the manufacturer with the product. Any use of the product not in conformance with the manufacturer's instructions may be dangerous.

Only items in this catalogue are carried in stock. Some items are subjected to minimum quantities or sold only in multiples of standard quantities. Please refer to the price list or contact our commercial department.

Balflex[®] – The European Technology

Balfit® Compression Ring Pipe Fittings



continued

Balfit® Metric Male Connector with seal – 34.106.

carbon steel parallel Metric thread male stud 24° compression ring pipe fitting with rubber seal

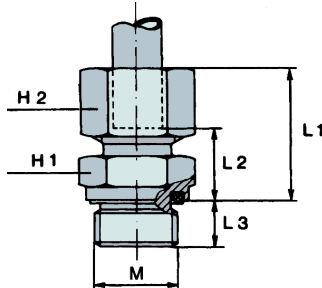

According to **ISO 8434-1** According to **DIN 2353**

Material: Carbon Steel

Finish: Zinc-plated

part number	Ø tube	thread	dimensions						working pressure	ISO series
			L1	L2	L3	H1	H2			
	mm	G							MPa	
34.106.10LM18	10	18x1,5	27,5	12,5	12	24	19		31.5	L
34.106.10LM22	10	22x1,5	29	14	14	27	19		31.5	L
34.106.12LM14	12	14x1,5	27	12,5	12	19	22		31.5	L
34.106.12LM18	12	18x1,5	27	12,5	12	24	22		31.5	L
34.106.12LM22	12	22x1,5	28,5	14	14	27	22		31.5	L
34.106.15LM16	15	16x1,5	28	13	12	24	27		31.5	L
34.106.15LM22	15	22x1,5	30	15	14	27	27		31.5	L
34.106.18LM18	18	18x1,5	30,5	14	12	27	32		31.5	L
34.106.22LM22	22	22x1,5	33	16,5	14	32	36		16.0	L
34.106.12SM22	12	22x1,5	33,5	17,5	14	27	24		63.0	S
34.106.16SM18	16	18x1,5	36,5	18	12	27	30		40.0	S

also available:

Balfit® Stainless Steel 24° Compression Ring

(add an 'S' at the end of the part number; ex: 34.106.16SM22S)

Construction characteristics and dimensions may be changed at any time without prior notice.

The data contained herein is information purposes only and does not enlarge, amend or imply any warranty other than provided by the manufacturer with the product. Any use of the product not in conformance with the manufacturer's instructions may be dangerous.

Only items in this catalogue are carried in stock. Some items are subjected to minimum quantities or sold only in multiples of standard quantities. Please refer to the price list or contact our commercial department.

Balflex® – The European Technology