

Balfit® Compression Ring Pipe Fittings

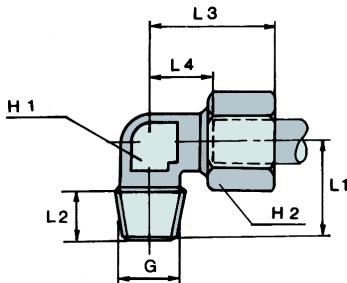

Balfit® NPTF Taper Elbow Male Connector – 34.121.

carbon steel NPTF thread male stud 24° standpipe adapter 90° elbow



According to **ISO 8434-1** According to **DIN 2353**

Material: Carbon Steel
Finish: Zinc-plated

| part number | Ø tube | thread | dimensions | | | | | | | working pressure | ISO series |
|---------------|--------|--------|------------|------|----|------|----|----|------|------------------|------------|
| | | | mm | G | L1 | L2 | L3 | L4 | H1 | | |
| 34.121.06LN02 | 6 | 1/8 | 20 | 10 | 27 | 12 | 12 | 14 | 31.5 | L | |
| 34.121.08LN04 | 8 | 1/4 | 26 | 15 | 29 | 14 | 12 | 17 | 31.5 | L | |
| 34.121.10LN04 | 10 | 1/4 | 27 | 15 | 30 | 15 | 14 | 19 | 31.5 | L | |
| 34.121.12LN06 | 12 | 3/8 | 28 | 15 | 32 | 17 | 17 | 22 | 31.5 | L | |
| 34.121.15LN08 | 15 | 1/2 | 34 | 19,5 | 36 | 21 | 19 | 27 | 31.5 | L | |
| 34.121.18LN08 | 18 | 1/2 | 36 | 19,5 | 40 | 23,5 | 24 | 32 | 31.5 | L | |
| 34.121.22LN12 | 22 | 3/4 | 42 | 20 | 44 | 27,5 | 27 | 36 | 16.0 | L | |
| 34.121.28LN16 | 28 | 1 | 48 | 25 | 47 | 30,5 | 36 | 41 | 16.0 | L | |
| 34.121.35LN20 | 35 | 1-1/4 | 54 | 25,5 | 56 | 34,5 | 41 | 50 | 16.0 | L | |
| 34.121.42LN24 | 42 | 1-1/2 | 61 | 26 | 63 | 40 | 50 | 60 | 16.0 | L | |
| 34.121.06SN04 | 6 | 1/4 | 26 | 15 | 31 | 16 | 12 | 17 | 63.0 | S | |
| 34.121.08SN04 | 8 | 1/4 | 27 | 15 | 32 | 17 | 14 | 19 | 63.0 | S | |
| 34.121.10SN06 | 10 | 3/8 | 28 | 15 | 34 | 17,5 | 17 | 22 | 63.0 | S | |
| 34.121.12SN06 | 12 | 3/8 | 28 | 15 | 38 | 21,5 | 17 | 24 | 63.0 | S | |
| 34.121.14SN08 | 14 | 1/2 | 34 | 19,5 | 40 | 22 | 19 | 27 | 63.0 | S | |
| 34.121.16SN08 | 16 | 1/2 | 36 | 19,5 | 43 | 24,5 | 24 | 30 | 40.0 | S | |
| 34.121.20SN12 | 20 | 3/4 | 42 | 20 | 48 | 26,5 | 27 | 36 | 40.0 | S | |
| 34.121.25SN16 | 25 | 1 | 48 | 25 | 54 | 30 | 36 | 46 | 40.0 | S | |
| 34.121.30SN20 | 30 | 1-1/4 | 54 | 25,5 | 62 | 35,5 | 41 | 50 | 40.0 | S | |
| 34.121.38SN24 | 38 | 1-1/2 | 61 | 26 | 72 | 41 | 50 | 60 | 31.5 | S | |
| 34.121.06LN04 | 6 | 1/4 | 26 | 15 | 29 | 14 | 12 | 14 | 31.5 | L | |
| 34.121.08LN02 | 8 | 1/8 | 24 | 10 | 29 | 14 | 12 | 17 | 31.5 | L | |

also available:

Balfit® Stainless Steel 24° Compression Ring

(add an 'S' at the end of the part number; ex: 34.121.12LN06)

continued on next page

Construction characteristics and dimensions may be changed at any time without prior notice.

The data contained herein is information purposes only and does not enlarge, amend or imply any warranty other than provided by the manufacturer with the product. Any use of the product not in conformance with the manufacturer's instructions may be dangerous.

Only items in this catalogue are carried in stock. Some items are subjected to minimum quantities or sold only in multiples of standard quantities. Please refer to the price list or contact our commercial department.

Balflex® – The European Technology



Balfit[®] Compression Ring Pipe Fittings

continued

Balfit[®] NPTF Taper Elbow Male Connector – 34.121.

carbon steel NPTF thread male stud 24° standpipe adapter 90° elbow

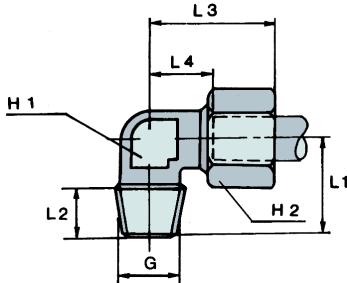

According to **ISO 8434-1** According to **DIN 2353**

Material: Carbon Steel

Finish: Zinc-plated

| part number | Ø tube | thread | dimensions | | | | | | | working pressure | ISO series |
|---------------|--------|--------|------------|------|----|------|----|----|------|------------------|------------|
| | mm | G | L1 | L2 | L3 | L4 | H1 | H2 | MPa | | |
| 34.121.08LN06 | 8 | 3/8 | 28 | 15 | 31 | 16 | 17 | 17 | 31.5 | L | |
| 34.121.08LN08 | 8 | 1/2 | 34 | 19,5 | 34 | 19 | 19 | 17 | 31.5 | L | |
| 34.121.10LN02 | 10 | 1/8 | 24 | 10 | 30 | 15 | 14 | 19 | 31.5 | L | |
| 34.121.10LN06 | 10 | 3/8 | 28 | 15 | 32 | 17 | 17 | 19 | 31.5 | L | |
| 34.121.10LN08 | 10 | 1/2 | 34 | 19,5 | 35 | 20 | 19 | 19 | 31.5 | L | |
| 34.121.12LN04 | 12 | 1/4 | 28 | 15 | 32 | 17 | 17 | 22 | 31.5 | L | |
| 34.121.12LN08 | 12 | 1/2 | 34 | 19,5 | 35 | 20 | 19 | 22 | 31.5 | L | |
| 34.121.15LN06 | 15 | 3/8 | 33 | 15 | 36 | 21 | 19 | 27 | 31.5 | L | |
| 34.121.18LN12 | 18 | 3/4 | 42 | 20 | 43 | 26,5 | 27 | 32 | 31.5 | L | |
| 34.121.12SN08 | 12 | 1/2 | 34 | 19,5 | 37 | 20,5 | 19 | 24 | 63.0 | S | |
| 34.121.14SN06 | 14 | 3/8 | 33 | 15 | 40 | 22 | 19 | 27 | 63.0 | S | |
| 34.121.16SN06 | 16 | 3/8 | 37 | 15 | 43 | 24,5 | 24 | 30 | 40.0 | S | |
| 34.121.20SN08 | 20 | 1/2 | 42 | 19,5 | 48 | 26,5 | 27 | 36 | 40.0 | S | |
| 34.121.25SN12 | 25 | 3/4 | 46 | 20 | 54 | 30 | 36 | 46 | 40.0 | S | |
| 34.121.30SN16 | 30 | 1 | 55 | 25 | 62 | 35,5 | 41 | 50 | 40.0 | S | |

also available:

Balfit[®] Stainless Steel 24° Compression Ring

(add an 'S' at the end of the part number; ex: 34.121.12LN04)

Construction characteristics and dimensions may be changed at any time without prior notice.

The data contained herein is information purposes only and does not enlarge, amend or imply any warranty other than provided by the manufacturer with the product. Any use of the product not in conformance with the manufacturer's instructions may be dangerous.

Only items in this catalogue are carried in stock. Some items are subjected to minimum quantities or sold only in multiples of standard quantities. Please refer to the price list or contact our commercial department.

Balflex[®] – The European Technology