

Balfit® Compression Ring Pipe Fittings

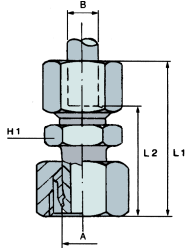

Balfit® Swivel Reducing Heavy Standpipe Connector– 34.154.

carbon steel swivel reducing 24° compression ring heavy standpipe connector



According to **ISO 8434-1** According to **DIN 2353**

Material: Carbon Steel
Finish: Zinc-plated

part number	Ø tube		dimensions						working pressure MPa	ISO series
	A	B	L1	L2	H1					
34.154.0806S	8	6	44	29	14				63.0	S
34.154.1006S	10	6	46,5	31,5	14				63.0	S
34.154.1206S	12	6	46	31	14				63.0	S
34.154.1406S	14	6	50	35	17				63.0	S
34.154.1208S	16	6	51	36	17				40.0	S
34.154.2006S	20	6	56,5	41,5	22				40.0	S
34.154.2506S	25	6	59	44	27				40.0	S
34.154.3006S	30	6	63,5	48,5	32				40.0	S
34.154.3806S	38	6	69,5	54,5	41				31.5	S
34.154.1008S	10	8	48,5	33,5	17				63.0	S
34.154.1208S	12	8	48	33	17				63.0	S
34.154.1408S	14	8	50	35	17				63.0	S
34.154.1608S	16	8	51	36	17				40.0	S
34.154.2008S	20	8	56,5	41,5	22				40.0	S
34.154.2508S	25	8	59	44	27				40.0	S
34.154.3008S	30	8	63,5	48,5	32				40.0	S
34.154.3808S	38	8	69,5	54,5	41				31.5	S
34.154.1210S	12	10	48,5	32,5	19				63.0	S
34.154.1410S	14	10	50,5	34,5	19				63.0	S
34.154.1610S	16	10	51,5	35,5	19				40.0	S
34.154.2010S	20	10	57	41	22				40.0	S
34.154.2510S	25	10	59,5	43,5	27				40.0	S

also available:

Balfit® Stainless Steel 24° Compression Ring

(add an 'S' at the end of the part number; ex: 34.154.3010S)

continued on next page

Construction characteristics and dimensions may be changed at any time without prior notice.

The data contained herein is information purposes only and does not enlarge, amend or imply any warranty other than provided by the manufacturer with the product. Any use of the product not in conformance with the manufacturer's instructions may be dangerous.

Only items in this catalogue are carried in stock. Some items are subjected to minimum quantities or sold only in multiples of standard quantities. Please refer to the price list or contact our commercial department.

Balflex® – The European Technology



Balfit[®] Compression Ring Pipe Fittings

continued

Balfit[®] Swivel Reducing Heavy Standpipe Connector – 34.154.

carbon steel swivel reducing 24° compression ring heavy standpipe connector

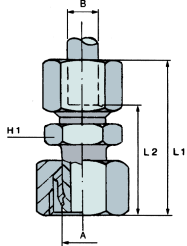

According to **ISO 8434-1** According to **DIN 2353**

Material: Carbon Steel
Finish: Zinc-plated

part number	Ø tube		dimensions						working pressure MPa	ISO series
	A	B	L1	L2	H1					
34.154.3010S	30	10	64	48	32				25.0	S
34.154.3810S	38	10	70	54	41				25.0	S
34.154.1412S	14	12	52,5	36,5	22				63.0	S
34.154.1612S	16	12	53,5	37,5	22				40.0	S
34.154.2012S	20	12	57	41	22				40.0	S
34.154.2512S	25	12	59,5	43,5	27				40.0	S
34.154.3012S	30	12	64	48	32				40.0	S
34.154.3812S	38	12	70	54	41				31.5	S
34.154.1614S	16	14	57	39	24				40.0	S
34.154.2014S	20	14	60,5	42,5	24				40.0	S
34.154.2514S	25	14	63	45	27				40.0	S
34.154.3014S	30	14	67,5	49,5	32				25.0	S
34.154.3814S	38	14	73,5	55,5	41				25.0	S
34.154.2016S	20	16	60,5	42	27				40.0	S
34.154.2516S	25	16	63	44,5	27				40.0	S
34.154.3016S	30	16	67,5	49	32				40.0	S
34.154.3816S	38	16	73,5	55	41				31.5	S
34.154.2520S	25	20	68	46,5	32				40.0	S
34.154.3020S	30	20	70,5	49	32				40.0	S
34.154.3820S	38	20	76,5	55	41				40.0	S
34.154.3025S	30	25	75,5	51,5	41				40.0	S
34.154.3825S	38	25	79,5	55,5	41				31.5	S
34.154.3830S	38	30	82,5	56	46				31.5	S

also available:

Balfit[®] Stainless Steel 24° Compression Ring

(add an 'S' at the end of the part number; ex: 34.154.3020S)

Construction characteristics and dimensions may be changed at any time without prior notice.

The data contained herein is information purposes only and does not enlarge, amend or imply any warranty other than provided by the manufacturer with the product. Any use of the product not in conformance with the manufacturer's instructions may be dangerous.

Only items in this catalogue are carried in stock. Some items are subjected to minimum quantities or sold only in multiples of standard quantities. Please refer to the price list or contact our commercial department.

Balflex[®] – The European Technology