

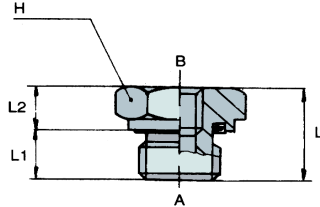

Balfit[®] Compression Ring Pipe Fittings

Balfit[®] Male-Female Stud Adapter – 34.174.

carbon steel parallel BSP thread male-female adapter with rubber seal



According to **ISO 8434-1** According to **DIN 2353**

Material: Carbon Steel
Finish: Zinc-plated

part number	Ø tube	thread	dimensions							working pressure	ISO series
	mm	G	Ø	L	L1			H		MPa	
34.174.06R02	3/8	1/8	22,5	12	10,5			22		63.0	S
34.174.08R02	1/2	1/8	24	14	10			27		63.0	S
34.174.08R04	1/2	1/4	24	14	10			27		63.0	S
34.174.12R04	3/4	1/4	26	16	10			32		40.0	S
34.174.12R06	3/4	3/8	26	16	10			32		40.0	S
34.174.16R04	1	1/4	29	18	11			41		40.0	S
34.174.16R06	1	3/8	29	18	11			41		40.0	S
34.174.16R08	1	1/2	29	18	11			41		40.0	S
34.174.20R08	1-1/4	1/2	32	20	12			50		40.0	S
34.174.20R12	1-1/4	3/4	32	20	12			50		40.0	S
34.174.24R08	1-1/2	1/2	36	22	14			55		31.5	S
34.174.24R12	1-1/2	3/4	36	22	14			55		31.5	S
34.174.24R16	1-1/2	1	36	22	14			55		31.5	S

also available:

Balfit[®] Stainless Steel 24° Compression Ring

(add an 'S' at the end of the part number; ex: 34.174.20R12)

Construction characteristics and dimensions may be changed at any time without prior notice.

The data contained herein is information purposes only and does not enlarge, amend or imply any warranty other than provided by the manufacturer with the product. Any use of the product not in conformance with the manufacturer's instructions may be dangerous.

Only items in this catalogue are carried in stock. Some items are subjected to minimum quantities or sold only in multiples of standard quantities. Please refer to the price list or contact our commercial department.

Balflex[®] – The European Technology