



Balfit[®] Compression Ring Pipe Fittings

Balfit[®] Banjo BSP Allow Screw – 34.181.

carbon steel parallel BSP thread banjo allow screw

Balfit[®] Banjo Metric Allow Screw – 34.182.

carbon steel parallel Metric thread banjo allow screw

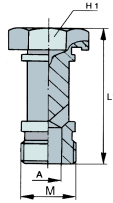
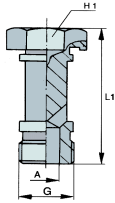

According to **ISO 8434-1** According to **DIN 2353**

Material: Carbon Steel

Finish: Zinc-plated

part number	Ø tube	thread	dimensions						ISO series
	mm	G / M	Ø	L	L1		H	Ø	
34.181.R02		1/8	4	32	17				L/S
34.181.R04		1/4	5	44	19				L/S
34.181.R06		3/8	8	50,5	24				L/S
34.181.R08		1/2	10	60,5	30				L/S
34.181.R12		3/4	14,5	70	36				L/S
34.181.R16		1	21	84,5	46				L/S
34.181.R20		1-1/4	26	100	55				L/S
34.181.R24		1-1/2	30	112	60				L/S

34.182.M08		8x1	3	32	14				L/S
34.182.M10		10x1	4	32	17				L/S
34.182.M12		12x1,5	4	44	19				L/S
34.182.M14		14x1,5	5	44	19				L/S
34.182.M16		16x1,5	8	50,5	24				L/S
34.182.M18		18x1,5	8	54	27				L/S
34.182.M20		20x1,5	10	59	30				L/S
34.182.M22		22x1,5	10	60,5	30				L/S
34.182.M26		26x1,5	14,5	70	36				L/S
34.182.M27		27x2	14,5	70	36				L/S
34.182.M33		33x2	21	84,5	46				L/S
34.182.M42		42x2	26	100	55				L/S
34.182.M48		48x2	30	112	60				L/S

also available:

Balfit[®] Stainless Steel 24° Compression Ring

(add an 'S' at the end of the part number; ex: 34.181.R12S)

Balfit[®] Stainless Steel 24° Compression Ring

(add an 'S' at the end of the part number; ex: 34.182.M18S)

Construction characteristics and dimensions may be changed at any time without prior notice.

The data contained herein is information purposes only and does not enlarge, amend or imply any warranty other than provided by the manufacturer with the product. Any use of the product not in conformance with the manufacturer's instructions may be dangerous.

Only items in this catalogue are carried in stock. Some items are subjected to minimum quantities or sold only in multiples of standard quantities. Please refer to the price list or contact our commercial department.

Balflex[®] – The European Technology